

KEY DISTANCE

- Hospital - 2 min
- School / College - 3 min
- Bank - 3 min
- Market - 1 min
- PMT Bus Stop - 1 min
- Petrol Pump - 1 min
- Paud Road - 1 min
- Chandani Chowk - 8 min
- Mumbai - Bangalore Highway - 8 min

LOCATION MAP

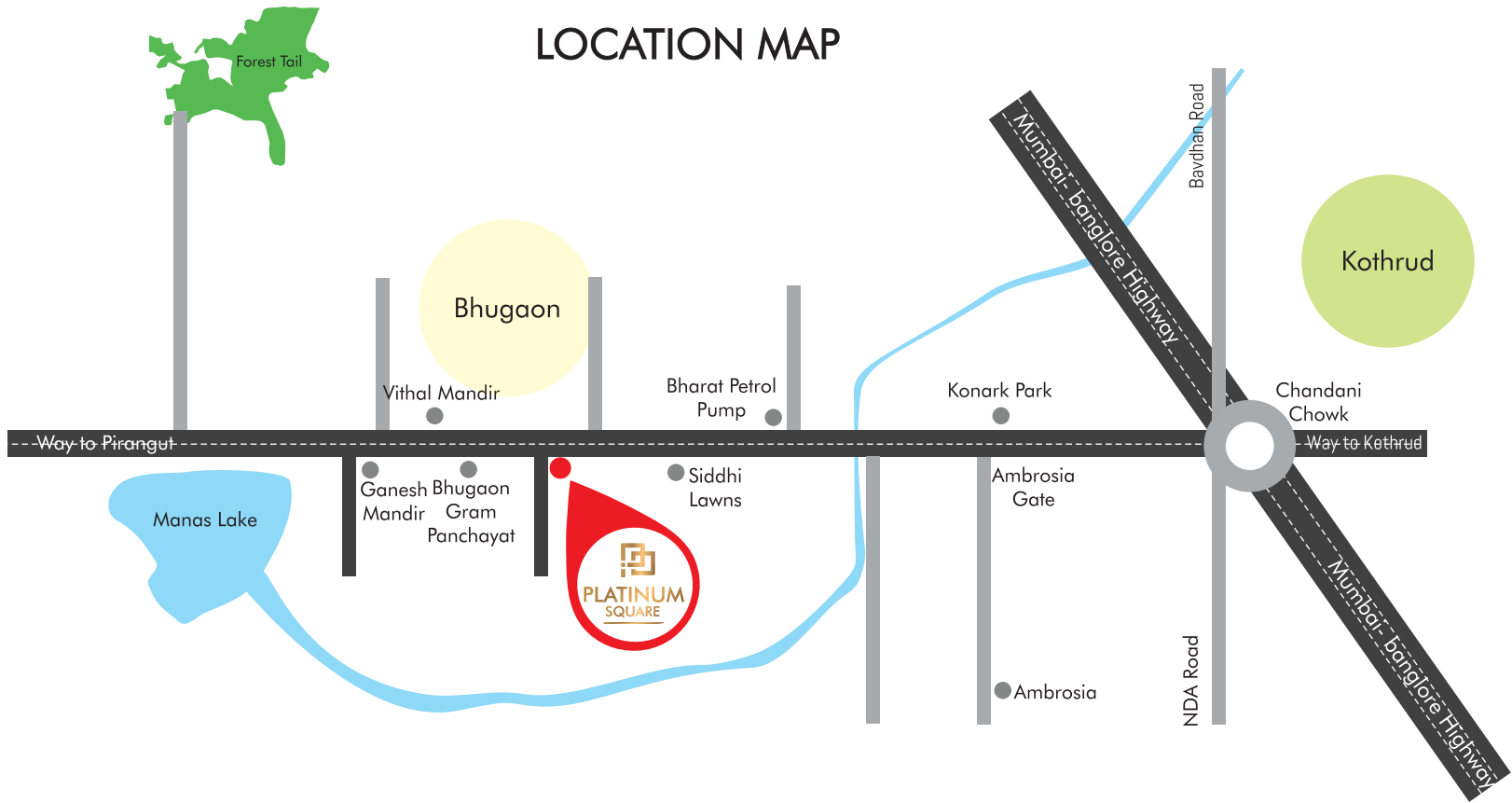

A PROJECT BY



+91 7276 299 227

SITE ADD: Platinum Square, Sr. 07/1/1, Near Padmavati Mandir, Paud Road, Bhugaon, Pune - 412 115

OFFICE ADD: Dangat Park, 501, Near Swarna Hotel, Warje, Pune - 411 058



RERA  
Registered Project

MAKE IN INDIA  
PIXELNINE 99 7575 6009

All Right Reserved  
This Brochure is purely conceptual and not a legal offering. The developer reserves all the rights to add, delete, alter any detail, specifications, elevation mentioned herein. The brochure is indicative of how the furniture can be arranged in the residential unit. No. furniture is to be supplied to purchaser by developer unless otherwise mentioned. All images, unless otherwise indicated are used for illustrative purpose only.



RERA  
Registered Project

1, 2 BHK LUXURIOUS HOMES & COMMERCIAL SPACES

A PROJECT BY









LOWER GROUND FLOOR PLAN

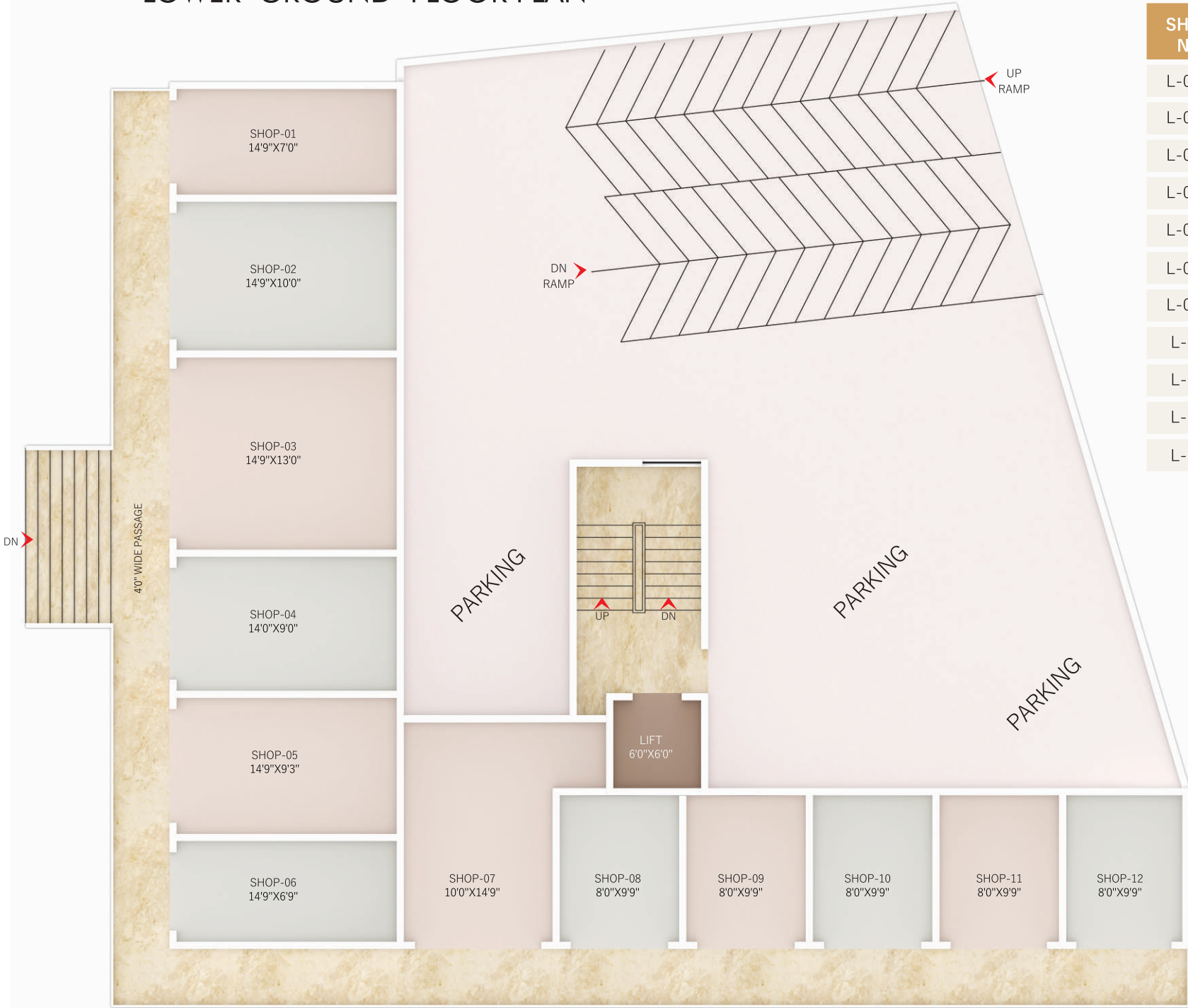

AREA STATEMENT

SHOP NO	CARPET AREA (SQ.FT)	SALABLE AREA (SQ.FT)
L-01	105.60	147.83
L-02	148.44	207.81
L-03	191.71	268.39
L-04	133.80	187.31
L-05	135.73	190.03
L-06	100.75	141.05
L-07	147.79	206.90
L-08	79.33	111.06
L-09	79.33	111.06
L-10	79.33	111.06
L-11	79.33	111.06

UPPER GROUND FLOOR PLAN



AREA STATEMENT

SHOP NO	CARPET AREA (SQ.FT)	SALABLE AREA (SQ.FT)
U-01	251.34	351.88
U-02	399.13	558.78
U-03	515.38	721.53
U-04	318.72	446.21
U-05	181.70	254.37
U-06	134.12	187.77
U-07	272.44	381.41
U-08	149.73	209.62
U-09	243.59	341.02
U-10	176.74	247.44
U-11	269.21	376.89

A PROJECT BY



A PROJECT BY







AREA STATEMENT

FLAT NO	CARPET AREA (SQ.FT)	SALABLE AREA (SQ.FT)
101, 201, 301, 401, 501, 601	517.42	698.52
102, 202, 302, 402, 502, 602	719.04	970.70
103, 203, 303, 403, 503, 603	609.78	823.20
104, 204, 304, 404, 504, 604	476.53	643.31
105, 205, 305, 405, 505, 605	493.31	665.97
106, 206, 306, 406, 506, 606	527.76	712.47



- A - ENTRANCE
- B - LIVING
- C - KITCHEN
- D - BEDROOM
- E - BATH
- F - W.C.
- G - BALCONY
- H - DRY BALCONY





# 2 BHK TYPICAL

- A - ENTRANCE
- B - LIVING
- C - KITCHEN
- D - BEDROOM
- E - BATH
- F - W.C./ TOILET
- G - BALCONY
- H - DRY BALCONY



## SPECIFICATIONS

- RCC :**
  - Earthquake-resistant framed structure
- BLOCKWORK :**
  - External Walls - 6" AAC Block work
  - Internal Walls - 5" AAC Block work
- PLASTER :**
  - External Walls - Double-coat plaster with water proofing chemical
  - Internal Walls – Single-coat plaster and POP finish for walls & ceilings
- FLOORING AND TILING :**
  - Vitrified 2'X2' flooring
  - Anti-skid ceramic flooring for toilets, Balcony and Terrace
- DOORS :**
  - Decorative main Entrance Door
  - PVC Door for Toilet, Bathroom & W.C.
  - French Door/ Sliding Door For Balcony
  - Flush Door For Dry Balcony
- WINDOWS :**
  - Aluminum powder-coated windows with mosquito net (wherever possible)
  - Granite four-side double-framed sill for all windows
- KITCHEN :**
  - Granite Kitchen platform with SS Sink
  - Designed Glazed Tile dado up to 7' height
  - Jaquar or equivalent make CP fittings

- WASHROOMS :**
  - Jaquar or equivalent make CP fittings
  - Dado tiles up to 7' height
  - Concealed CPVC / UPVC plumbing with diverter/ Mixer for hot & cold water
  - Provision for water heater & exhaust fan
  - Wash Basin in every Flat
- ELECTRIFICATION :**
  - Concealed Electrical Piping
  - Branded MCB & ELCB (Earth Leakage Circuit Breaker)
  - Adequate points with branded modular switches (Anchor/Roma/Legrand)
  - Provision For Ac And inverter Point
  - TV points for living room and bedroom
- PAINTING :**
  - Apex paint for all external walls
  - OBD paint for all internal walls
- LIFT :**
  - Lift with standard make
  - ARD Sytem / Battery Backup



# TOP TERRACE AMENITIES

- Pathway
- Children Pay Area
- Party Area
- Yoga Area
- Senior Citizen sitting
- Open Gym
- Ganapati Mandir
- Sitting Bench



# AMENITIES

- Elegant entrance lobby
- Well designed top terrace
- Solar water heater system
- 2 & 4 wheeler Parking
- Automatic door elevator of reputed make
- Sensor Lights For Passage
- CCTV cameras for Common Area
- Power backup (DG) for lift, Common area lighting
- Shop Name Standee Board (Common)
- Sufficient Hot and Cold Water
- Rain Water harvesting
- ARD System For Lift

A PROJECT BY  
**Jagdamb** DEVELOPERS  
**PLATINUM** PROMOTERS

